

HORIZONTAL WICKING GARDEN BED INSTALLATION

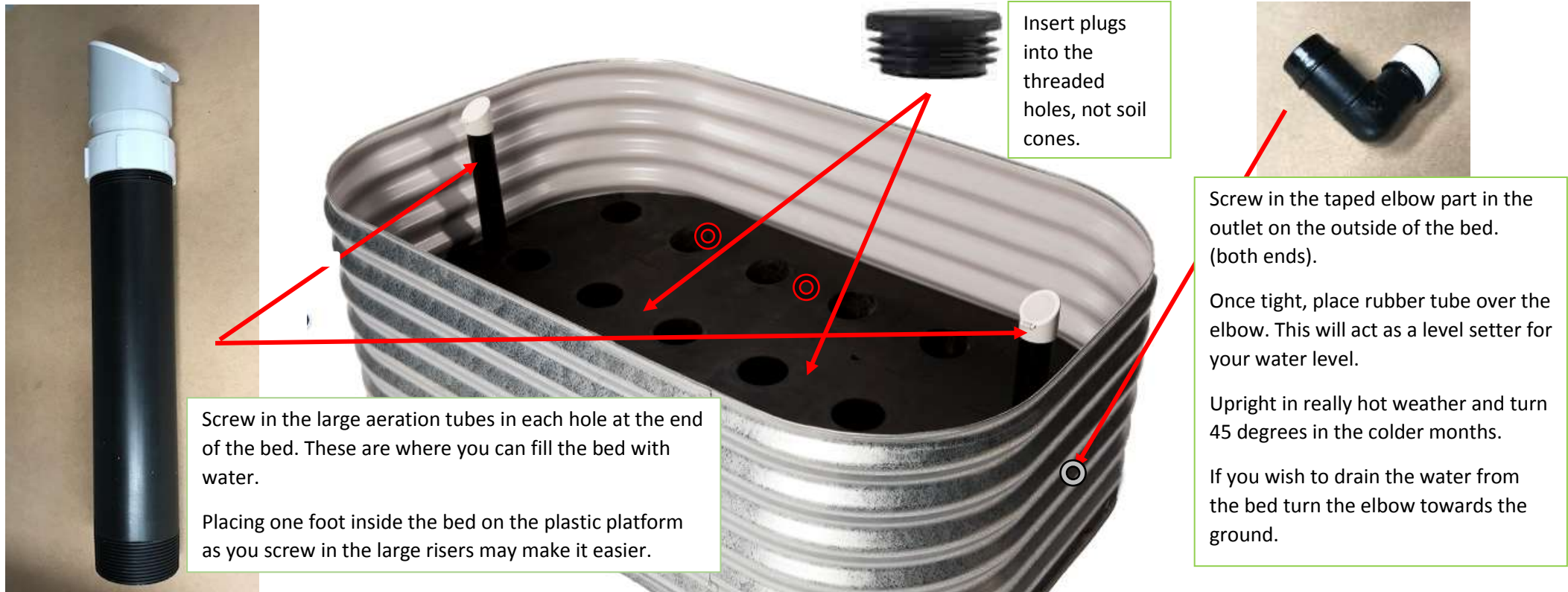

Screw in the large aeration tubes in each hole at the end of the bed. These are where you can fill the bed with water.

Placing one foot inside the bed on the plastic platform as you screw in the large risers may make it easier.

Insert plugs into the threaded holes, not soil cones.

Screw in the taped elbow part in the outlet on the outside of the bed. (both ends).
Once tight, place rubber tube over the elbow. This will act as a level setter for your water level.
Upright in really hot weather and turn 45 degrees in the colder months.
If you wish to drain the water from the bed turn the elbow towards the ground.

IMPORTANT NOTE:

Planter should be located on top of a clean, level surface free of sharp rocks or protrusions. This should be either concrete, pavers or timber. Otherwise the base should be a 20mm layer of blue metal stone, not clay. Extend the base to 150mm beyond the planter base to prevent rodents from burrowing under and erosion. Wash the sides of the beds 6 monthly to remove any dirt splash from the rain as this may lead to premature failure of the galvanising.

Make sure you use a good quality potting mix, in your advanced wicking garden beds.

WHEN INSTALLING ANY BIOFILTA PRODUCTS ON DECKS, ROOFTOPS, BALCONIES OR ANY OTHER RAISED STRUCTURE PLEASE CONTACT A PROFESSIONAL SUCH AS STRUCTURAL ENGINEER TO ENSURE THE STRUCTURE HAS THE APPROPRIATE LOAD BEARING CAPACITY AND IS STRUCTURALLY SOUND. THE TOTAL WEIGHT OF THE PRODUCT, SOIL AND WATER NEEDS TO BE TAKEN INTO ACCOUNT.

DO NOT PLACE BIOFILTA PRODUCTS WITHIN 900MM OF A BALCONY WALL OR POOL FENCE AS THEY MAY BECOME A CLIMBING STRUCTURE FOR SMALL CHILDREN